

WIFI CARD/BOX Quick Setting Guide

1. Hardware Preparation

A) Attach antenna to the wifi box



B) Connect the power supply adaptor to the DC IN 12V port on the WIFI BOX and plug the other end of the adaptor to the wall socket



WIFI BOX 12V/1A adapter specification

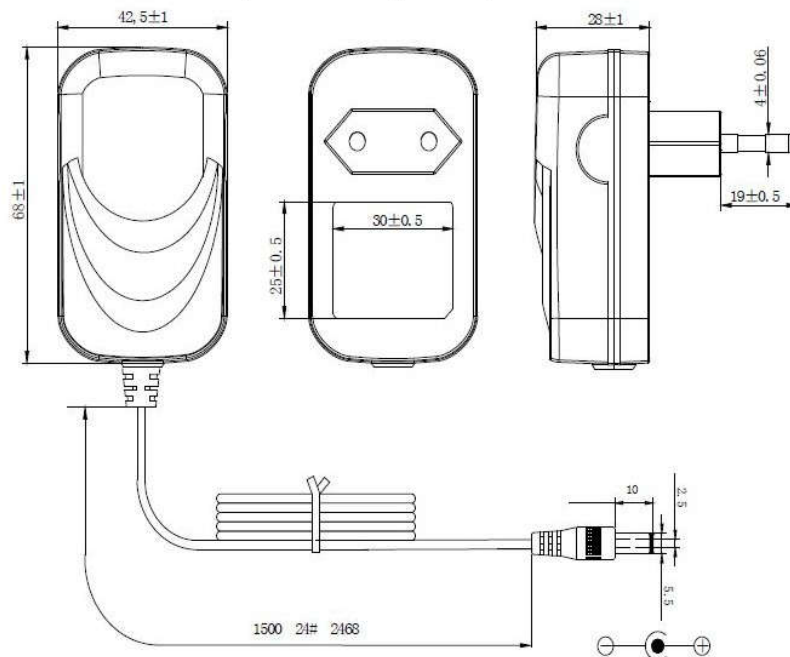

C) Connect the RS232 cable between inverter's RS232 port and WIFI BOX

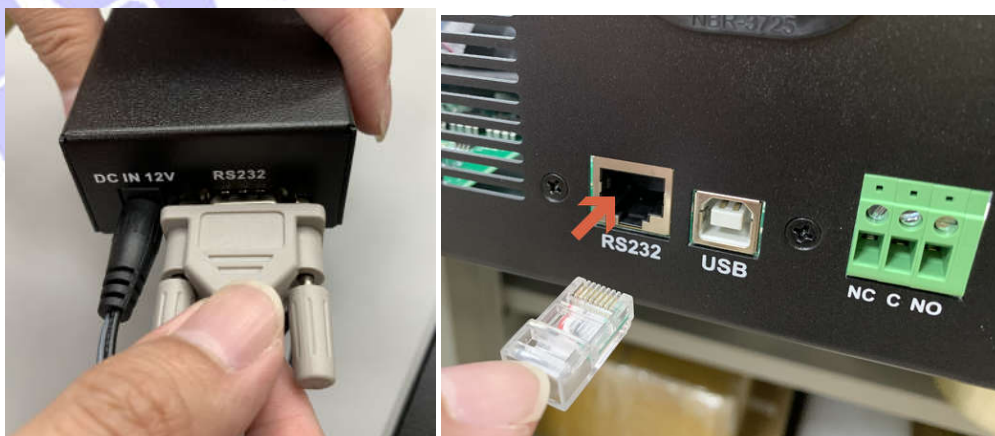

D) Green LED on WIFI BOX should be lit and stay ON solid after a few seconds.



TIP: if the green LED is off or keeps flashing, disconnect all cables from WIFI BOX and open cover to reset jumper. First, refer to picture below and verify that the **UC3** jumper must stay in 1-2 position. Next, check **UC2** jumper and verify that it should be in position 1-2; then, reset **UC2** jumper by changing to position 2-3, and then power OFF/ON WIFI BOX again which will reset to factory setting. Finally, in order to proceed with setup, you must change **UC2** jumper back to 1-2 position again. Once you have a **SOLID**

green LED, you are ready to proceed to software configuration. Otherwise, please repeat steps here until you see a SOLID green LED.

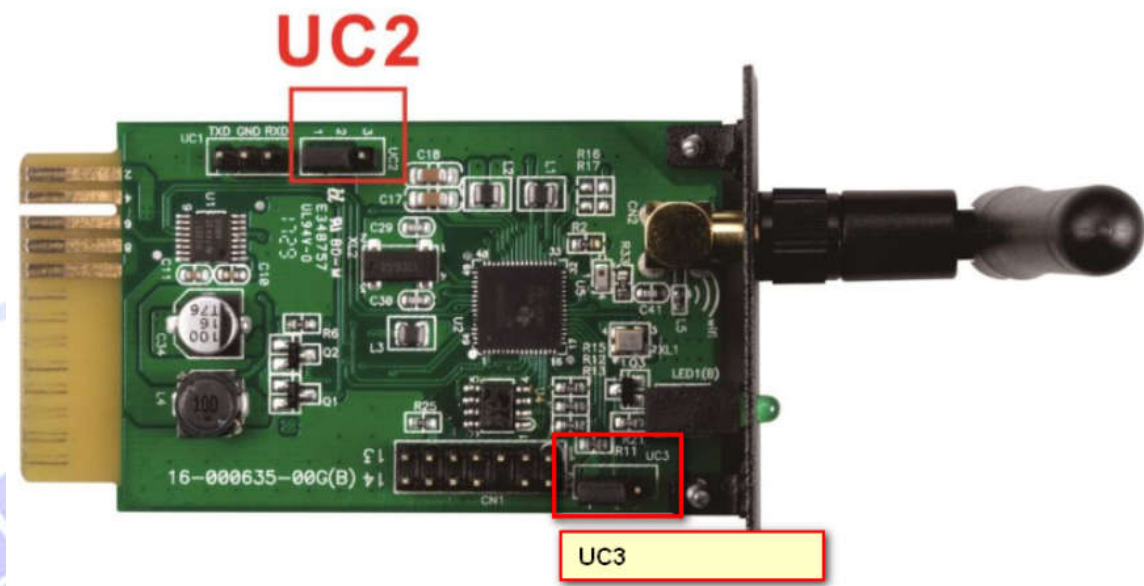

2. software configuration

A).Use cell phone or computer/laptop to connect to a WIFI access point named “wifi card” like below. If prompted for a password, enter “open”.



B).Open browser and type in web address <http://192.168.1.1>

Note: while you are in this step, you won't be able to connect to external Web. This is normal.

C).Select **System Information**

When you enter to wifi box setting web, please first confirm status indicators appear same as below: upload (red), UART (green).

Status	
Upload:	✗ Tx:00000 Rx:00000
UART:	✔ Tx:01535 Rx:00385

C).select **Application Config** and select the correct Time Zone and Daylight setting then click “apply”.

Hello, WIFI Card!

System Information **Application Config** Network Config Diagnostic Tools

Time

SNTP Server1: time.windows.com

SNTP Server2: time-a.nist.gov

SNTP Server3: time.apple.com

Time Zone: UTC+08:00

Daylight saving time: Disable

Apply

Note: please make sure you enter the correct Time Zone or else data may not be uploaded correctly.

D).Please click the **Network Config / Add Profile** and enter SSID, Security Type, and Security Key information from your home WIFI access point. This will direct the WIFI BOX to upload inverter data through your home WIFI so please make sure the data is entered correctly, or else upload will fail. Click “Add” when ready. The information will be added in the **STA Profiles** shown directly below.

Hello, WIFI Card!

System Information Application Config **Network Config** Diagnostic Tools

Add Profile

SSID: Enter your SSID

Security Type: Open WEP WPA1 WPA2

Security Key: Enter your password Hexadecimal digits - any combination of 0-9, a-f and A-F

Profile Priority: 0 Choose a value 0-7 (0 = highest)

Add

STA Profiles

1. bert	Security: WPA	Priority: 0
2. -	Security: -	Priority: -

TIP: if you're not sure what to enter for SSID information, see below.

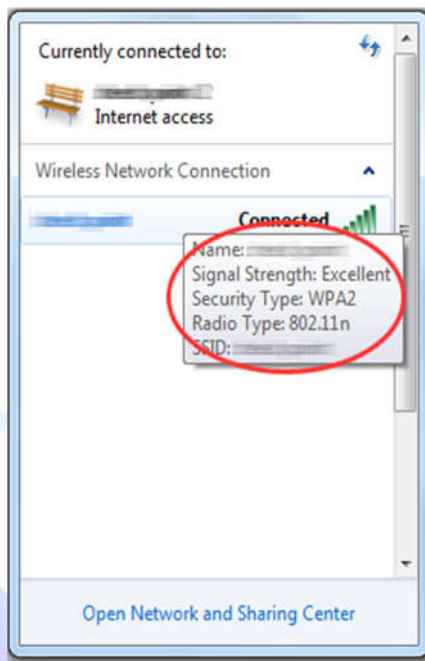

SSID: It means the wireless network identification name. If you use the wifi name-mppsolar to connect internet, the SSID is mppsolar.

Security type: WPA2 (you can find this information from laptop as below:

1. Please move the mouse to the wifi access point name which will show security type information.
2. Please right click on the wifi access point name--> view connection properties
3. Control panel-->Network and Internet-->View network status and tasks--> connection-->wireless properties-->Security

Security key: login the wireless network identification name password. It is necessary to keep confidential.

E) Network Config / Device Role

Finally, select the "Station Mode" and click on the Apply button. If you do not see any response on screen – THIS IS NORMAL. Manually turn off WIFI BOX by removing power supply and RS232 cables and then reconnect – this will restart the WIFI BOX.

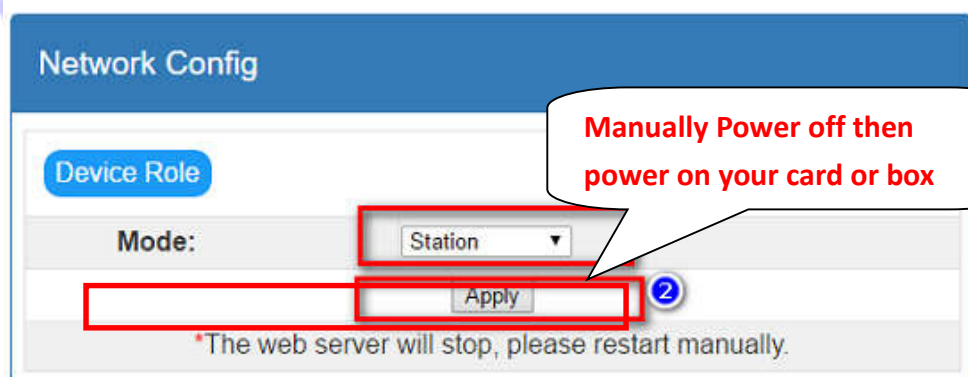

At this point if everything is setup correctly, the WIFI BOX will have obtained a IP from your home router and therefore accessible by typing "192.168.x.x" (depending on actual IP assigned) through your browser. A successful setup can be verified below by noting that the two indicator lights are now both **green**. (note: this step is NOT necessary; it is only for verification)

System Information	
Status	
Upload:	Tx:00024 Rx:00024
UART:	Tx:03430 Rx:01369
Device	
Device Name:	wificard
Device ID:	WIFICARDTEST001
Device Mode:	Station
System Time:	2017-10-23 15:50:45
System Up Time:	0 days 00:27:29

3. Data Center (Cloud)

A) Please enter the web address <http://power-datacenter.com> then register an account first.

Data Center

Home / System login

System login

User name

Password

Language

English

Login

There is no account? [register now](#)

Data Center

Home / Create account

Create account

* **User name**

* **Password**

* **Confirm password**

* **Company/Name**

Address

Contact

Telephone

* **E-mail**

Confirm

B) Log in

Data Center

Home / System login

System login

User name

Password

Language

English

Login

There is no account? [register now](#)

Once you successfully logged in, you will see the following screen and based on the numbers assigned to

each quadrant, follow the setup in this order: Location Manager → User Manager → Device Manager → Monitor

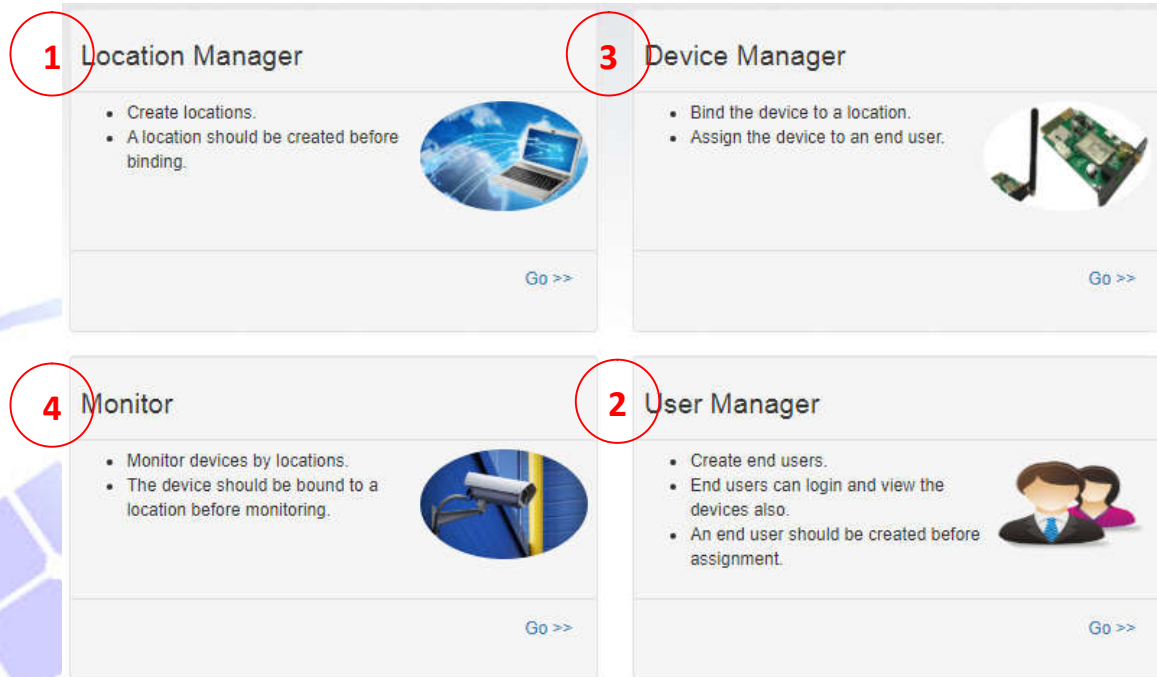

C) Location Manager

The Location Manager interface consists of two main parts:

- Location list table:** A table with columns: Location name, Address, Contact, Telephone, E-mail, and actions (Delete, Edit). The 'Create' button is highlighted in red.
- Create form:** A form with fields for Location name, Address, Contact, Telephone, and E-mail. The 'Create' button is highlighted in red.

D) User Manager

The User Manager interface consists of two main parts:

- User list table:** A table with columns: User name, Company/Name, Address, Contact, Telephone, E-mail, Role, and Creat time. The 'Create' button is highlighted in red.
- Create form:** A form with fields for User name, Role, Password, Company/Name, Address, Contact, Telephone, and E-mail. The 'Create' button is highlighted in red.

E) Device Manager

Bind Device:

- Device: fill in the **serial number of the monitored device**. (Serial number label is on the side of inverter).
 - Device name: assign a name so that the users can directly identify the device.
 - Device type: select the type of monitoring device e.g. Off Grid or Hybrid Inverter
 - Location name: select the bound location of monitored device.
- When you finish the content, please click the **Bind** button.

Bind device		Assign device	
Device	92931312100028	Device name	Inverter 5KVA
Device type	Hybrid Inverter	Location name	5#4F
Browse		Bind	
List			

Assign device: *Do this only if you wish to assign the device to multiple locations and end users*

Bind device		Assign device	
Device type		Location name	
Device	96121609100001	End user	
Browse		Assign	
List			

- Device type/ Location name: The pull-down value may vary depending on different devices.
 - Device: Select Device (unit's serial number).
 - End user: Select one of the end-users.
- Click the "assign" to complete the assignment.

F) Monitor: select "Monitor" from the main page and a successful monitoring setup will appear like below

Location : TestLocation

Card ID	12344678
SN	55355535553555

WiFi

2016/11/15 09:51:480 minutes ago

PV input power	0	W
Grid voltage	0	V
Battery capacity	100	%

Browse

Delete

Location : TestLocation2